

# C47 Electric 230v

YewdaleDefiant® Cassetted Blinds

yewdaleDefiant®  
FABRIC AND BLIND SYSTEMS



## C47 Electric 230v

### Features:

The YewdaleDefiant® C47 electric cassette blind with side channels features a motor as standard. The cassette is designed for top or face fix and accommodates a 40mm grooved aluminium barrel, housing the 230v AC motor. The motor is controlled by a switch which may be surface or flush mounted (not supplied as standard). Fabric is locked into a groove in the barrel with studs fitted at the edge of the fabric to retain it within the side channels. Aluminium bottom bar. Black or white hardware as standard.

### Benefits:

The C47 offers a premium electric operated cassetted blind for situations where durability and functionality are required. Our square and rounded cassette headboxes look stylish and suits a range of settings. The quiet and reliable motor is housed within the barrel and further protected by the robust aluminium headbox housing. The fabric is locked into the barrel and bottom bar and will give years of trouble-free use. For easy repair or replacement of blind cover, the fabric is located in the groove which allows it to be slid out sideways.

The C47 electric cassette blind benefits from a reduced installation time due to our goalpost installation method. The side channels are connected to the headbox via special end plates, creating a goalpost-shaped frame. The frame is then installed via the side channels.

### Options:

Square or rounded headbox; Black or white hardware; Remote and/or group control systems in place of single switch; Tracker fabric retaining system; Available in any RAL colour; Goalpost installation method.

### Specification:

The YewdaleDefiant® C47-90/120 electric cassetted blind with side channels as manufactured by Yewdale, +44 (0)1268 570900. Flame retardant fabric from the YewdaleDefiant® range, locked into grooved 53/70mm aluminium barrel along with aluminium bottom bar as standard. 230v AC motor is housed within black/white aluminium cassette with side channels and bottom bar. Please note: caution should be used when installing in drafty conditions - blinds should not be left down in the situation of open windows.

## Cassetted Blind Profile Dimension Guide

Model	Cassette Size (HxD)	Barrel Size Ø	Side Channel Size (WxD)
C47-90	Rounded / Square - 105 x 95mm	53mm	55 x 13mm
C47-120	Rounded / Square - 140 x 120mm	53 / 70mm	55 x 13mm

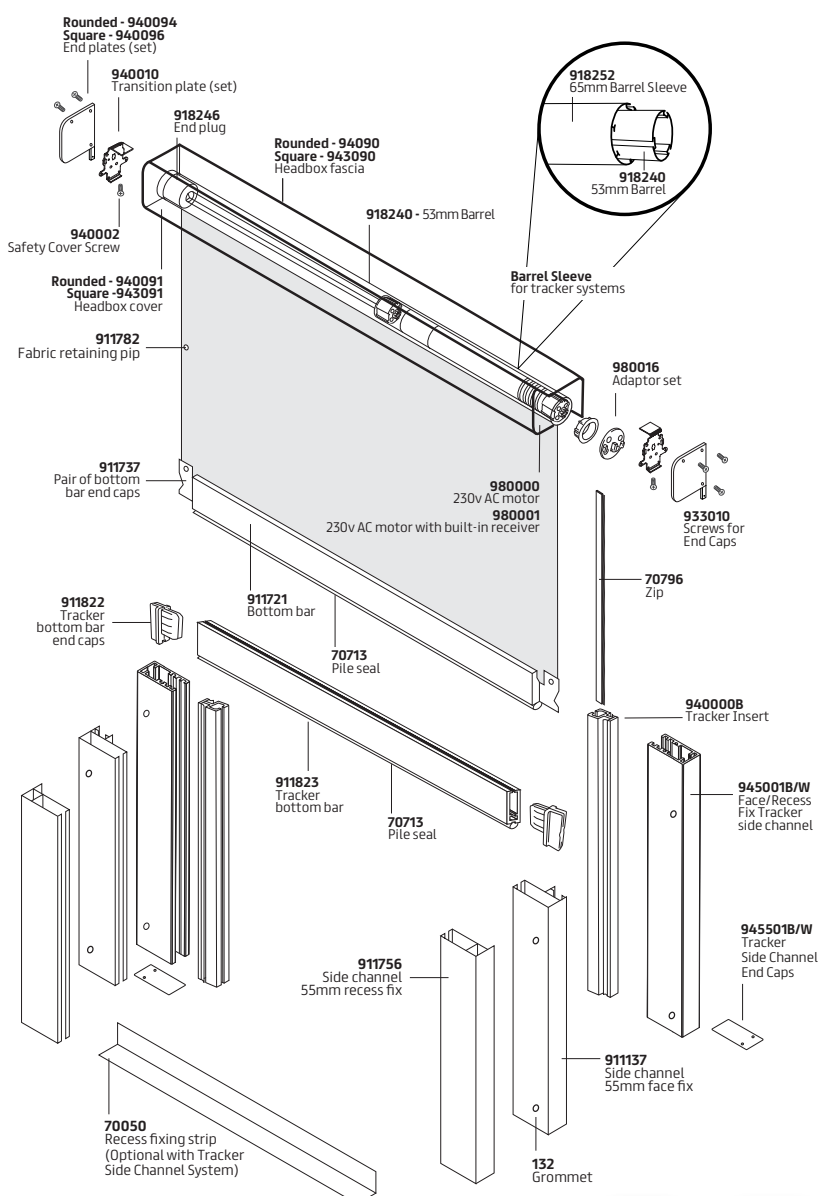

Find this product on  
NBS Source



yewdale.co.uk  
see things differently

Call: +44 (0)1268 570900 Fax: +44 (0)1268 732509 Email: sales@yewdale.co.uk  
Yewdale, Enterprise Way, Wickford, Essex, SS11 8DH | 4 Sutton Lane, London, EC1M 5PU