



Standard Bottom Bar Featured



C24 Crank

Features:

The YewdaleDefiant® C24 crank control cassette blind features a compact, robust 1:3 gear mechanism operated by a detachable crank handle. The cassette is designed for top or face fixing and accommodates 45, 53 or 70mm grooved aluminium barrels, depending on blind size and fabric weight. The fabric is locked into a groove in the barrel. It has an aluminium Tear Drop bottom bar and black or white hardware as standard.

- Quick and easy installation
- Block light with powder coated end plates
- Dedicated support team available to assist with installation and product enquiries
- Blackout options available

Benefits:

Our square and rounded headboxes are a good choice for a vast range of applications. With its powerful gear controls, the C24 will perform dependably in all kinds of contract applications. The geared crank handle and mechanism ensures smooth blind control and is safer for areas where cords are a threat. Fabric locked into the barrel and supported by sturdy supports.

Options:

Square or rounded headboxes; Black or white hardware; Fixed crank handle; With side channels C44S-90/120. Wire side-guiding system; Available in any RAL colour.

Specification:

YewdaleDefiant® C24-90/120 crank control cassetted blind as manufactured by Yewdale, +44 (0)1268 570900. Flame retardant fabric from the YewdaleDefiant® range, locked into grooved 45/53/70mm aluminium barrel along with aluminium bottom bar as standard. Robust vandal resistant 1:3½ crank mechanism and pin end housed within black/white aluminium cassette, supported by sturdy brackets.

Cassetted Blind Profile Dimension Guide

Model	Cassette Size (HxD)	Barrel Size Ø	Side Channel Size (WxD)
C24-90	Rounded / Square - 105 x 95mm	45mm	N/A
C24-120	Rounded / Square - 140 x 120mm	53 / 70mm	N/A

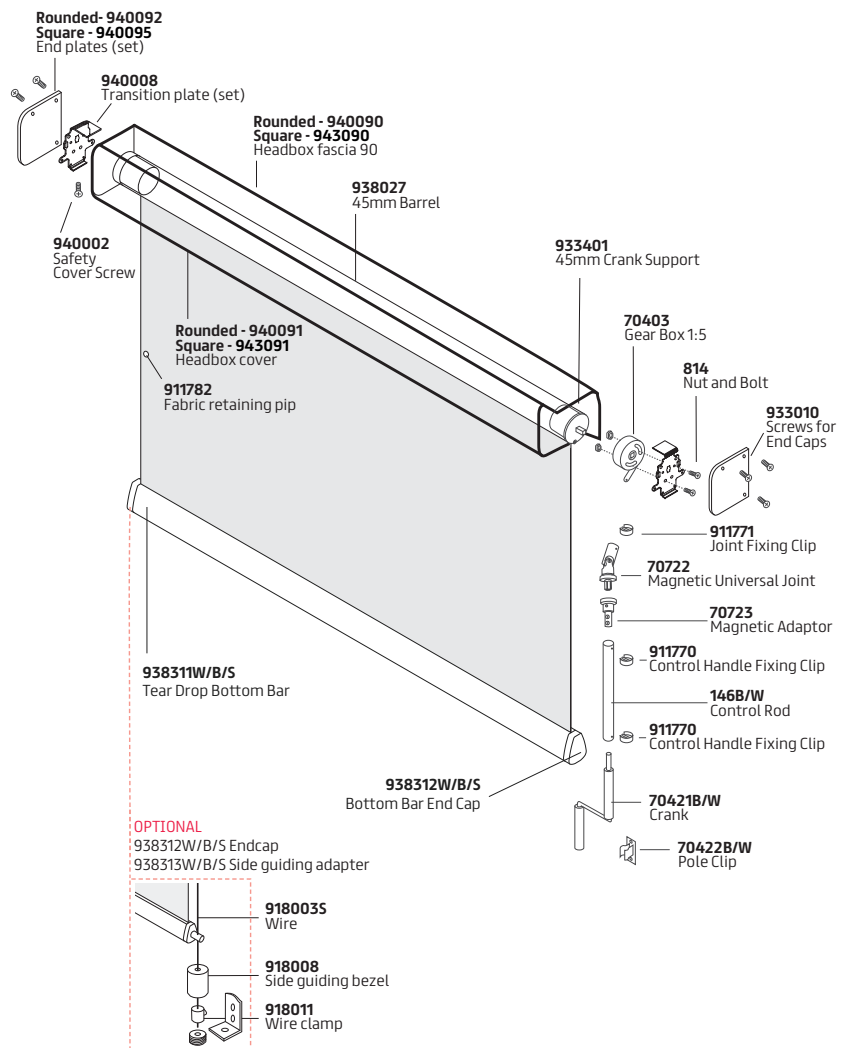

Find this product on
NBS Source



Cassette Headbox

Recommended Installation Clearance

yewdale **Defiant**[®]
FABRIC AND BLIND SYSTEMS

Cassette 60

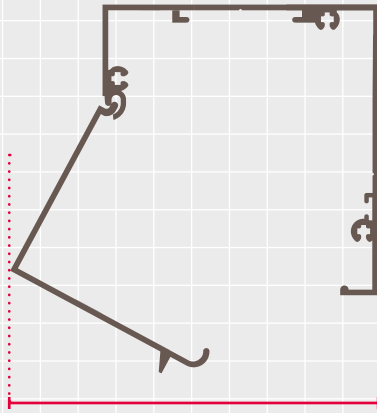

Min. Required: 95mm

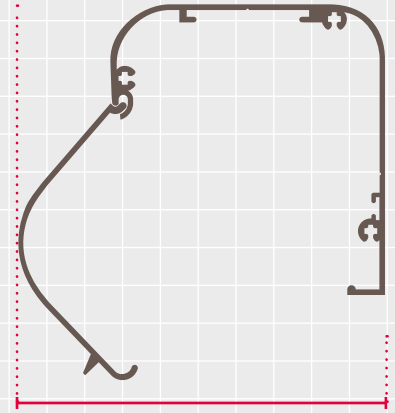

Min. Required: 95mm

Cassette 90

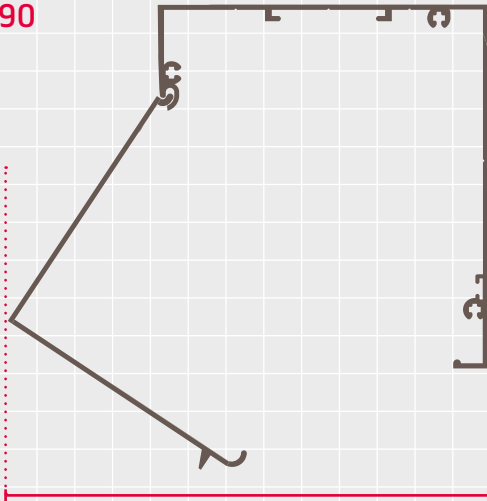

Min. Required: 145mm

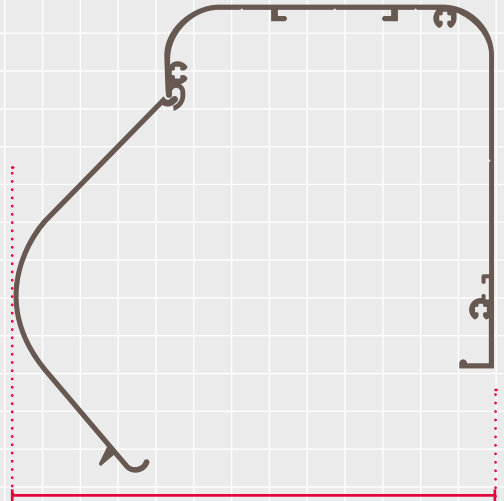

Min. Required: 145mm

Cassette 120

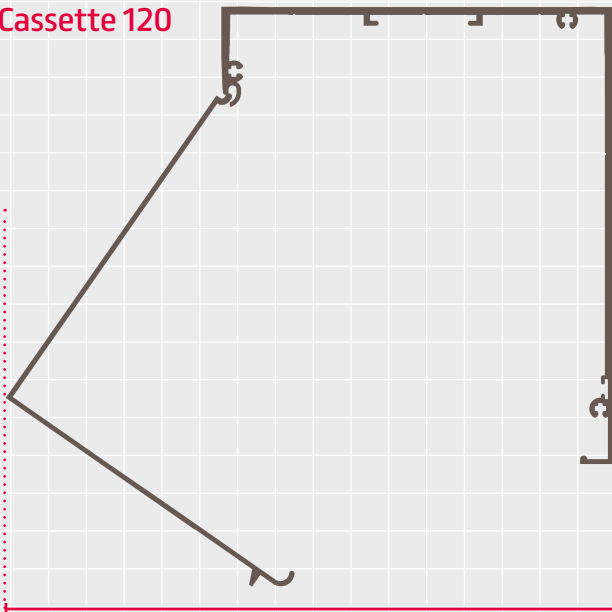

Min. Required: 185mm

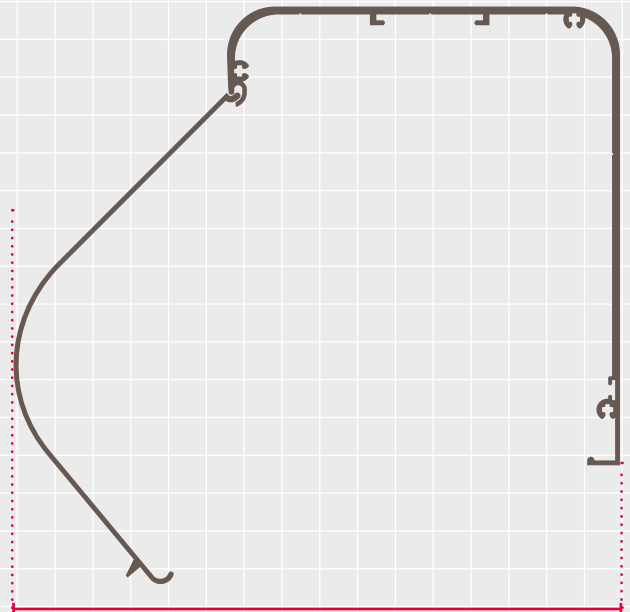

Min. Required: 185mm

All dimensions shown are indicative guidance only. The contractor/installer is responsible for verifying minimum space requirements prior to installation.