

C25 Electric 24v

YewdaleDefiant® Cassetted Blinds

yewdaleDefiant®
FABRIC AND BLIND SYSTEMS



C25 Electric 24v

Features:

The YewdaleDefiant® C25 electric cassette blind features a modern headbox constructed from durable aluminium. It's supplied with a low voltage 24v DC motor as standard. Designed for top or face fixing, this cassette accommodates a 40mm grooved aluminium barrel which houses the 24v DC motor. The motor is controlled by a switch which may be surface or flush mounted (not supplied as standard). Black or white hardware as standard.

Benefits:

Our cassette blinds can be manufactured with a square or rounded headbox. Fingertip control and a slim yet sturdy aluminium frame help this blind to lend an air of luxury to any environment and makes the C25 a perfect choice for motorised requirements. The quiet and reliable motor is housed within the barrel and supported by sturdy, metal brackets. Fabric is locked into a groove in the barrel and an aluminium bottom bar.

Options:

Square or rounded headboxes; Black or white hardware; Remote and/or group control systems in place of single switch; With side channels C45S-60/90. Wire side-guiding system; Available in any RAL colour.

Specification:

YewdaleDefiant® C25-60/90 low voltage electric cassetted blind as manufactured by Yewdale, +44(0)1268 570900. Flame retardant fabric from the YewdaleDefiant® range, locked into grooved 40mm aluminium barrel along with aluminium bottom bar as standard. Low voltage 24v DC motor is housed within black/white aluminium cassette.

Cassetted Blind Profile Dimension Guide

Model	Cassette Size (HxD)	Barrel Size Ø	Side Channel Size (WxD)
C25-60	Rounded / Square - 77 x 73mm	40mm	n/a
C25-90	Rounded / Square - 105 x 95mm	40mm	n/a

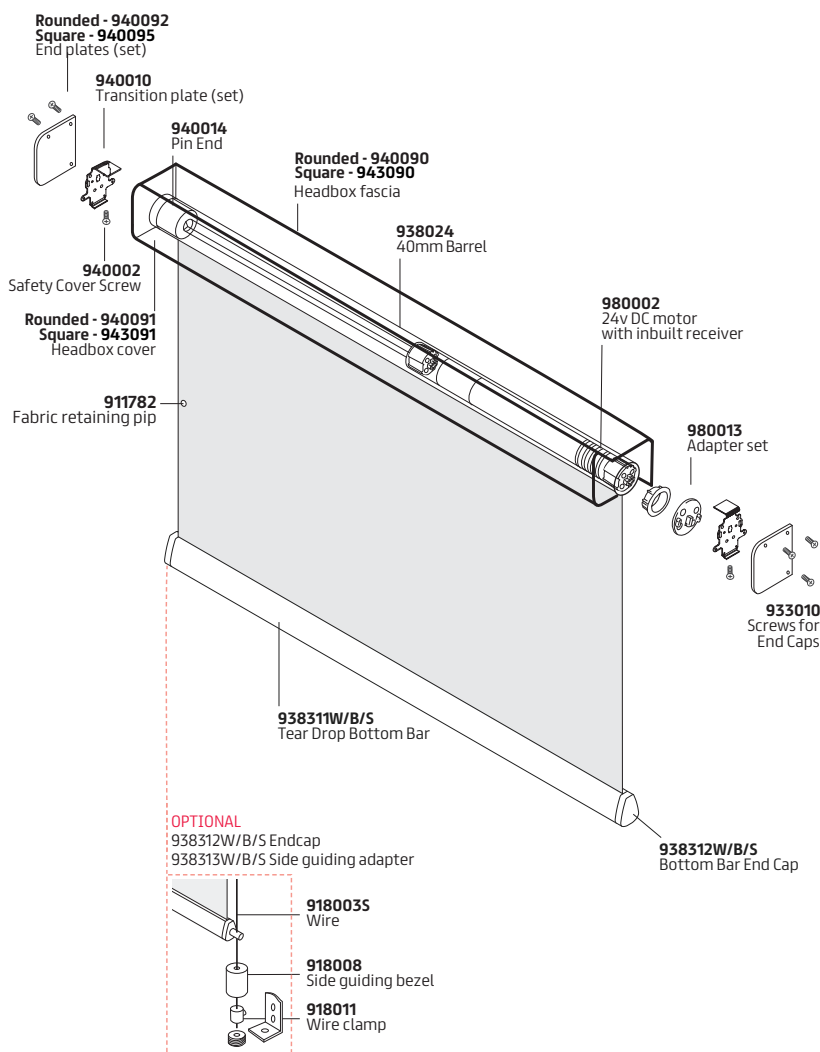

Find this product on
NBS Source



yewdale.co.uk
see things differently

Call: +44 (0)1268 570900 Fax: +44 (0)1268 732509 Email: sales@yewdale.co.uk
Yewdale, Enterprise Way, Wickford, Essex, SS11 8DH | 4 Sutton Lane, London, EC1M 5PU