

# R57 Overhead Electric

YewdaleDefiant® Roller Blinds

yewdaleDefiant®  
FABRIC AND BLIND SYSTEMS



## R57 Overhead Electric

### Features:

The YewdaleDefiant® overhead roller blind system with 230v AC motor. White aluminium brackets for top or face fixing with 50mm smooth aluminium barrel. The motor is controlled by a switch which may be surface or flush mounted (not supplied). Fabric is mounted onto a sprung 57mm aluminium barrel whilst at the other end it is fitted to a white Tear Drop aluminium bottom bar, attached to two draw tapes. These tapes are attached, between flanged guides, to the 50mm drive barrel, operated by a 230v AC electric motor.

### Benefits:

The R57 roller blinds are the ultimate in choice for the shading requirements for sloping or horizontal roof windows. With heavy duty componentry and a powerful spring action to the fabric roller, these blinds may be confidently specified for awkward or inaccessible locations. The R57 can be supplied with a number of remote or group control options including Radio Control and home automation systems.

### Options:

Tear Drop aluminium bottom bar in black or silver; Remote and/or group control systems.

### Specification:

YewdaleDefiant® R57 electric operation overhead roller blind with 230v AC motor as manufactured by Yewdale, +44 (0)1268 570900. Flame retardant fabric from the YewdaleDefiant® range, on 57mm aluminium barrel with enclosed spring attached to white Tear Drop aluminium bottom bar as standard. 50mm drive barrel connected to electric motor operates blind by means of draw-tapes to the bottom bar. Supported by sturdy, attractive brackets.

## Roller Blind Specification Guide

Model	Min Width	Max Width	Max Drop	Max M <sup>2</sup>
R57 Overhead Electric	570	2500	2000	4.0

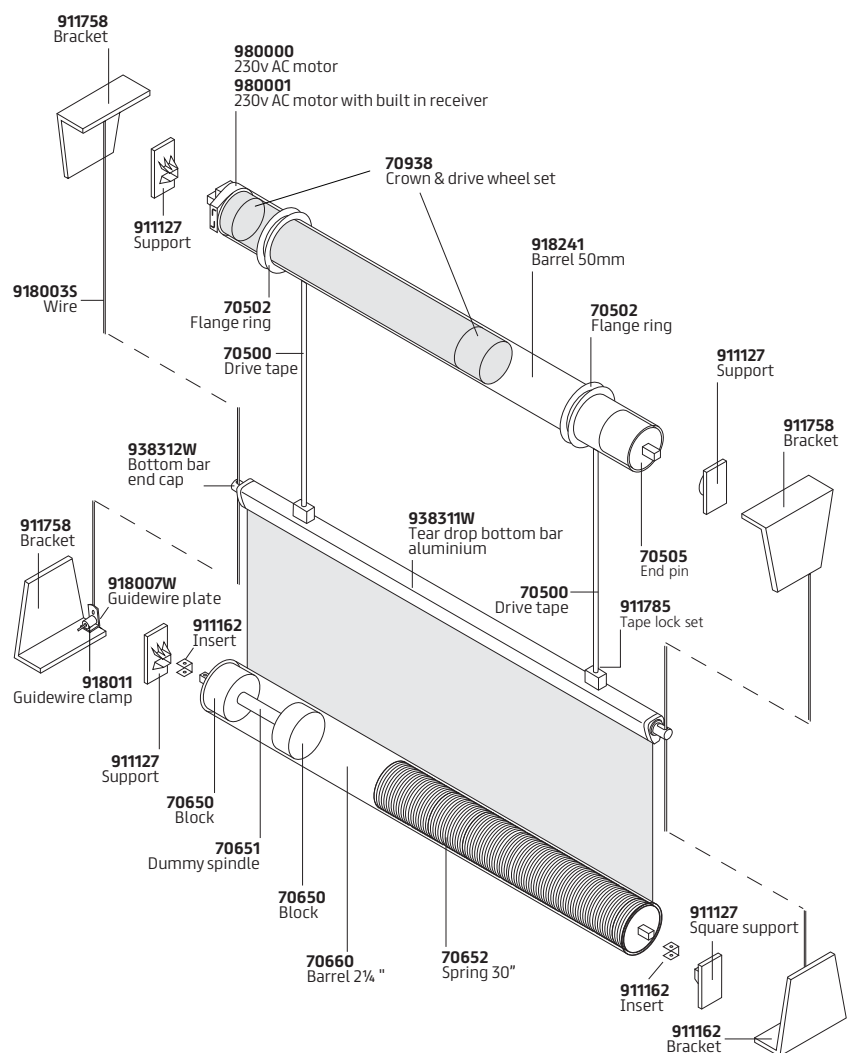

Find this product on  
NBS Source



yewdale.co.uk  
see things differently

Call: +44 (0)1268 570900 Fax: +44 (0)1268 732509 Email: sales@yewdale.co.uk  
Yewdale, Enterprise Way, Wickford, Essex, SS11 8DH | 4 Sutton Lane, London, EC1M 5PU